



Luminaire Schedule									
Symbol	Qty	Label	Arrangement	[MANUFAC]	Description	LLF	Luminaire Lumens	Luminaire Watts	Total Watts
	1	WM	Single	SIGNIFY GARDCO	ECF-S-48L-1A-WW-G2-4	0.900	19836	158.7	158.7
	3	A-HIS	Single	Gardco	ECF-S-48L-1A-WW-G2-4-HIS	0.900	15553	158.7	476.1

Calculation Summary									
Label	CalcType	Units	Avg	Max	Min	Avg/Min	Max/Min	PtSpcLr	Grid Z
PROPERTY LINE	Illuminance	Fc	0.06	0.4	0.0	N.A.	N.A.	10	N.A.
SITE	Illuminance	Fc	1.67	4.0	0.3	5.57	13.33	10	0

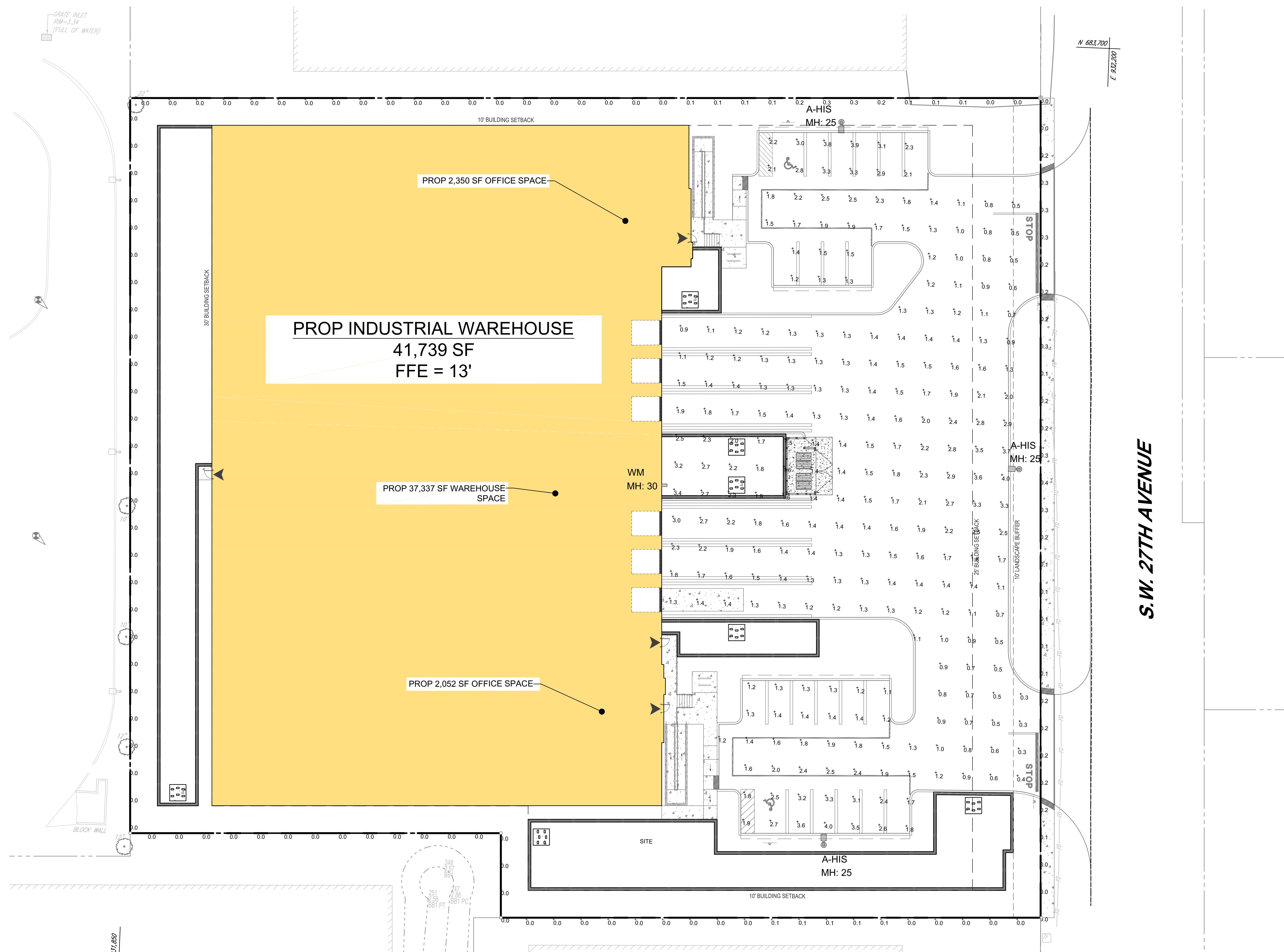
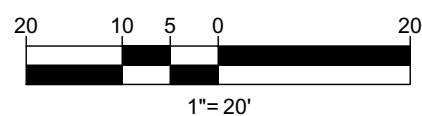

DPR
ENGINEERING
ARCHITECTURE
CONSTRUCTION
DESIGN
SERVICES

PZ22-12000-009
02/01/2023

BOHLER

12000009
/2023

SITE CIVIL AND CONSULTING ENGINEERING
LAND SURVEYING
PROGRAM MANAGEMENT
LANDSCAPE ARCHITECTURE
SUSTAINABLE DESIGN
PERMITTING SERVICES
TRANSPORTATION SERVICES

THE INFORMATION, DESIGN AND CONTENT OF THIS PLAN ARE PROPRIETARY AND SHALL NOT BE COPIED OR USED FOR ANY PURPOSE WITHOUT THE WRITTEN PERMISSION OF BOHLER ENGINEERING, INC.

REVISIONS

[illegible]

**Know what's below.
Call before you dig.**
ALWAYS CALL 811
It's fast. It's free. It's the law.

SITE PLAN SET

THIS DRAWING IS INTENDED FOR MUNICIPAL AND/OR AGENCY
REVIEW AND APPROVAL. IT IS NOT INTENDED AS A CONSTRUCTION
DOCUMENT UNLESS INDICATED OTHERWISE.

PROJECT No.:	FLB210118
DRAWN BY:	HD
CHECKED BY:	CL
DATE:	02/21/2022
CAD I.D.:	----

PROJECT:

**PROP.
SITE PLAN
DOCUMENTS**

- FOR -



ALLIANCE HP

GATEWAY INDUSTRIAL
SW 27TH AVENUE
POMPANO BEACH, FL 33069

BOHLER //

1900 NW CORPORATE BOULEVARD
SUITE 101E
BOCA RATON, FLORIDA 33431
Phone: (561) 571-0280
Fax: (561) 571-0281
FLORIDA BUSINESS CERT. OF AUTH. No. 30780



THIS ITEM HAS BEEN DIGITALLY SIGNED AND SEALED BY
MOHAMMED MEROUANE EL KAOUSSI, PE, ON THE DATE
ADJACENT TO THE SEAL. PRINTED COPIES OF THIS
DOCUMENT ARE NOT CONSIDERED SIGNED AND SEALED
AND THE SIGNATURE MUST BE VERIFIED ON ANY
ELECTRONIC COPIES.

SHEET TITLE:

LIGHTING PLAN

SHEET NUMBER:

C-801

ORG. DATE - 02/21/2022